

**INSTRUCTIONS  
&  
MAINTENANCE**

**TORO** Toro Australia Pty Ltd

## Introduction

---

Many thanks for choosing the Kombi Spray Machine from Toro Australia Pty Ltd. The most versatile and cost effective line marking and spray machine on the market today.

Toro are a worldwide leader and a complete supplier of quality products for the turf industry.

Of course it's just not the machines that Toro have available, their range of line marking paints suit your Kombi better than any other, wherever the pitch, whatever the occasion.

For more details on any of the products in Toro's range please log onto [www.toro.com.au](http://www.toro.com.au)

Specification:

Capacity: tank 25ltr, water reservoir 6.5ltr

Weight: 26.5kg Dry-up-to 70kg wet

Noise output: less than 70db

## Assembly

---

### Assembling your Kombi Line Marker

- Carefully remove the machine and the extras from the box
- Insert handlebar; adjust to suit the user's height. Tighten by using the thumb screw
- Charge the Kombi
- Connect the charging plug into the socket located above battery under the bonnet

### Attaching the Knib to the Kombi

- Remove the Knib from the packaging
- Front Marking. Push onto fitting at front of machine, and tighten
- Side Marking. Loosen screw (KOM00980) and rotate plastic arm (KOM01470) 90° and retighten screw. Locate Knib on wheel axle and secure with thumbscrew. Knib should be in trailing position behind axle.

### Optional Extras Available (not included)

- Athletic Boom for Running tracks
- Spray boom for pedestrian spraying
- Spray lance for free hand spraying
- Spray tips: Large Red 04 (high flow) Medium Blue 03 (Medium Flow) – Small Yellow 02 (lower flow)
- 1 Litre bottle holder for colours
- Rough Terrain Knib (KOMB01517)
- Knib Pivot (KOM01424)

**Caution: only use charger type provided**

## Battery Charger

---

The charger is only suitable for charging 18 AMP-Hour Sealed Lead Acid batteries as fitted to the Kombi machine.

Under no circumstances should this charger be used to charge any other battery types.

**WARNING:** Explosive gases. Prevent flames and sparks. Must only be charged in well ventilated areas.

Disconnect power supply before making or breaking the connection to the charger/machine.

Use only indoors and store in a dry place.

In the event of any damage occurring to the charger, do not use – Return to the manufacturer for repairs.

Toro recommend a circuit breaker should be used with all battery charges.

# To Operate the Kombi

Charging the machine:

- Connect plug into charger socket (located above battery)
- Switch on charger and leave for twelve hours
- If the machine is not used for over one week the battery should be fully charged before use.
- When all green light is lit on the battery charger the battery is fully charged
- If the red light on the battery charger is illuminated this indicates the machine needs charging.
- Disconnect supply before making or breaking the connections to the battery.
- Warning: Battery charger should not be used with any non-rechargeable batteries or batteries other than that with in the Kombi machine.
- During charging the battery must be placed in a well ventilated area.
- Young Children should be supervised to ensure that they do not play with the appliance.

## Line Width Adjustment:

Pull Knob upwards (KOM01476) and select desired line width  
Predetermined widths of 1.5" 2" 3" and 4" as marked

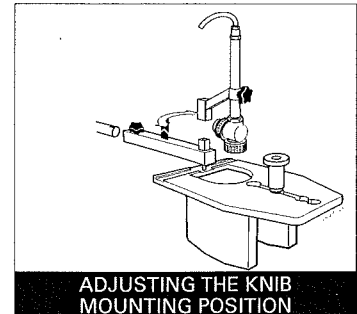

## Kombi Diagram

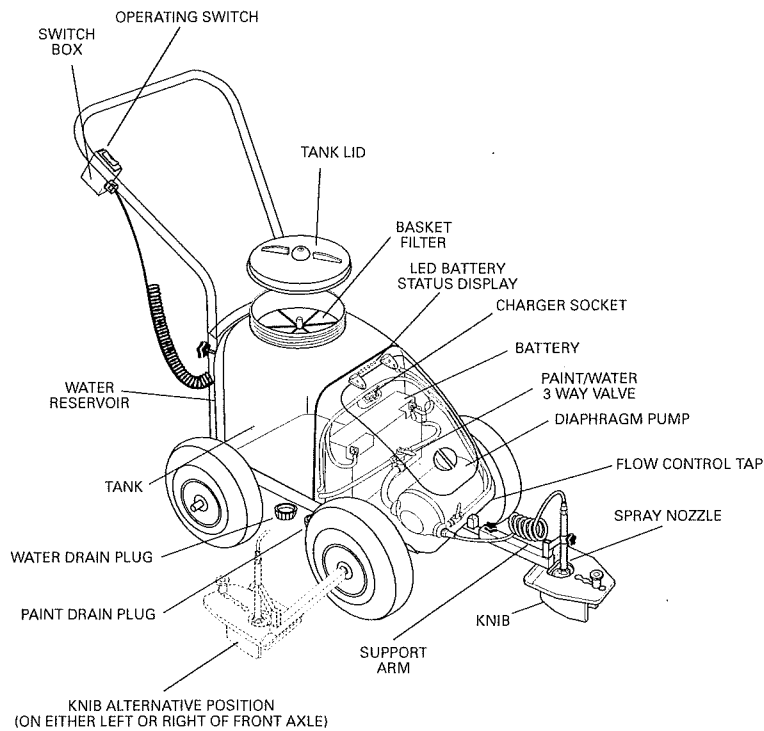

## Marking

To Begin Marking:

- Ensure the battery is fully charged
- Make sure the filter is in position
- Fill tank with required level of water and then add Toro paint
- Ensure Paint/Water tap is on paint
- Circulate paint by opening flow control tap
- Screw lid down securely
- To begin marking set flow control tap to required position, switch on and walk forward at desired marking speed

## Coloured Markings

Coloured Toro paint can be used in the main tank. If operator does not wish to use the main tank, the inlet hose and filter can be placed in a separate container. Ensure that the Flow Control Valve is closed.

This eliminates the need to clean colours from main tank.

Container holders that fix onto rear of Kombi are available, as an optional extra.

# Warranty

The Kombi is capable of producing outstanding lines.

The Kombi pump has been matched for ultimate performance and reliability when used with Toro paint.

The Kombi is guaranteed against any manufacturing defects. Any manufacturing defects will be corrected/replaced as soon as possible.

The Kombi is not guaranteed against normal wear and tear.

When used with Toro paint the pump is guaranteed for 12 months, when machine is registered using the warranty registration card.

# Maintenance

After every marking session flush the system through by turning the paint/water tap to water.

Switch the machine on until clean water is sprayed. If the flow control valve was used, purge the return pipe by opening flow control.

Clean the tank, this can be done by spraying water into the tank with the nozzle assembly.

If machine is going to be left for more than 24 hours without marking you should drain the paint from the tank by removing the cap. If the cap is tight this may be loosened with spanner provided.

Always rinse out the basket filter.

Re-charge the battery ready for the next days marking.

It is particularly important to drain the main tank regularly in cold weather (less than 5°C).

In cold weather the water tank can be filled with hot (not boiling) water to serve as a thermal jacket for the paint. Water should not be hotter than a person could comfortably place their hand in.

Keep all moving parts regularly lubricated.

# Parts

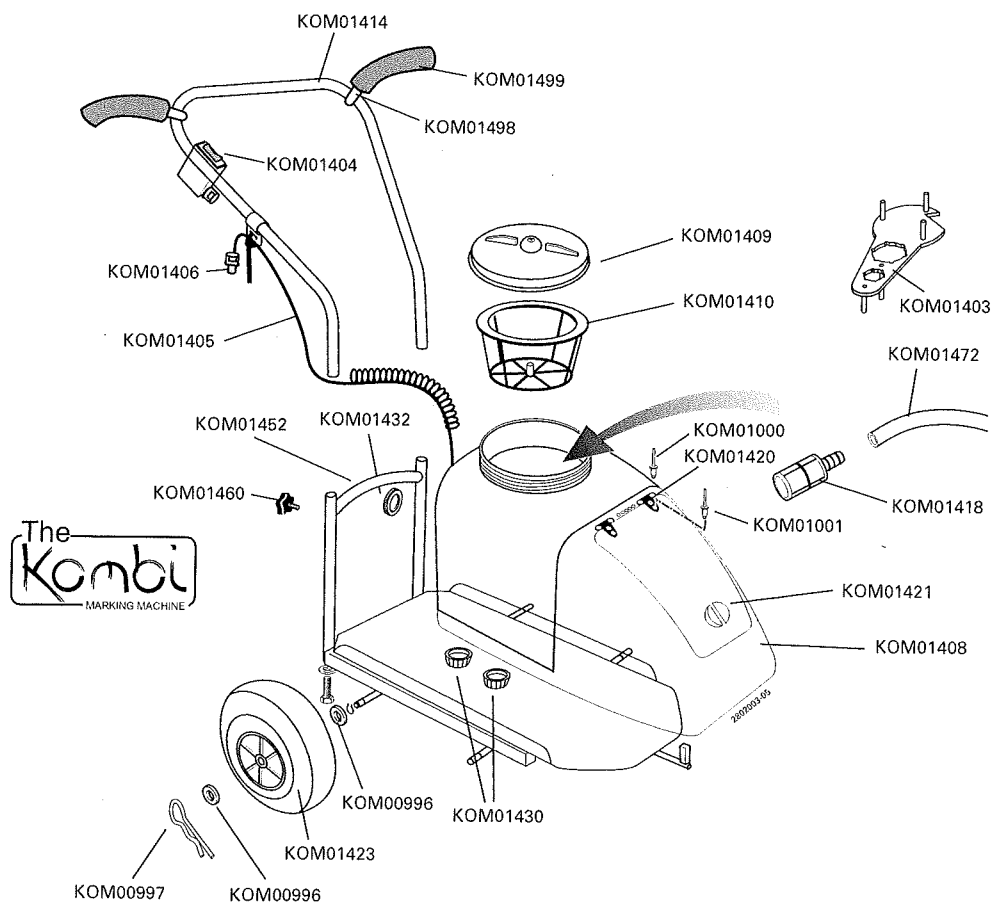

# Paint Mixing

## Blinder:

Specially formulated product to give an extremely bright line. A concentrated paint with the following recommended dilution rates:

First Mark – 1 part Blinder to 5 parts water

Over marking – 1 part Blinder and between 5 and 25 parts water

## Fastline:

High quality product to give a bright line. A concentrated paint with the following recommended dilution rates:

First Mark – 1 part Fastline to 5 parts

Over marking – 1 part Fastline and between 5 and 14 parts water

# Parts

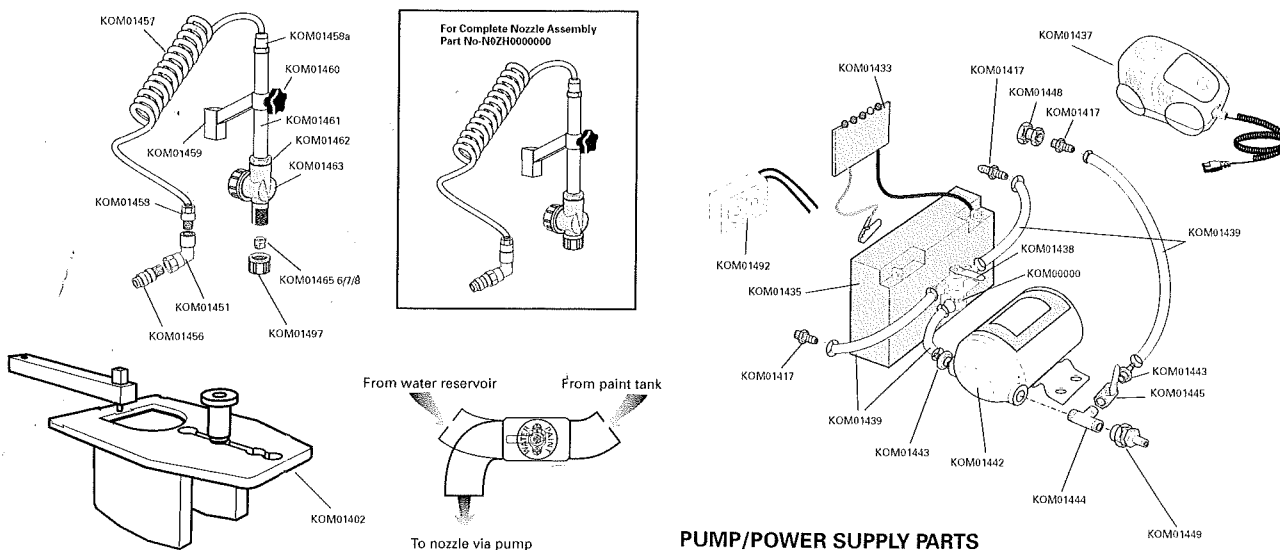

# Problem Solving

## Problem

Machine does not spray but pump is running

## Possible cause & solutions

1. Are you using Toro paint? The pump has been selected for use with Toro paint.
2. No liquid in selected tank (paint/water).
3. Airllock – switch tap to water. Uncouple Flexi-hose connection, located on the outside at the front of machine, when water comes through switch off and re-couple.
4. Blockage – Remove nozzle tip and clean.
5. Check Tank Filter.

Switch on, but pump does not work

1. Check battery status.
2. Ensure plug is connected into back of switch.
3. Check battery and pump connections.

If problems persist, contact your local dealer, the helpline or contact Toro Australia from web [www.toro.com.au](http://www.toro.com.au)

Pump is pulsating

The material is too thick. Add a small amount of water and/or adjust flow control valve.

Battery is not charging

Check battery with meter. Check connections. Check charger connections.

Status display does not light up.

1. Battery is totally flat. Charge battery.
2. Check that status display connection is not broken.

The information contained in this leaflet is produced in good faith, and Toro Australia believes it to be correct at the time of printing. Toro Australia reserves the right to alter without notice the design and content of the Kombi.